

22b Vincent Street Edithvale

Bedroom	4
Bathroom	2
Powder Room	2
Living	2
Walk in Robe	1
Single Garage	1

Area Summary

Land Size	324m ²
Ground Floor	123.43m ²
First Floor	88.98m ²
Garage	26.30m ²
TOTAL	238.71m ² / 25.69sq

These plans are the property of Lowe Design & Build and cannot be reproduced in any form without prior written consent.

First Floor

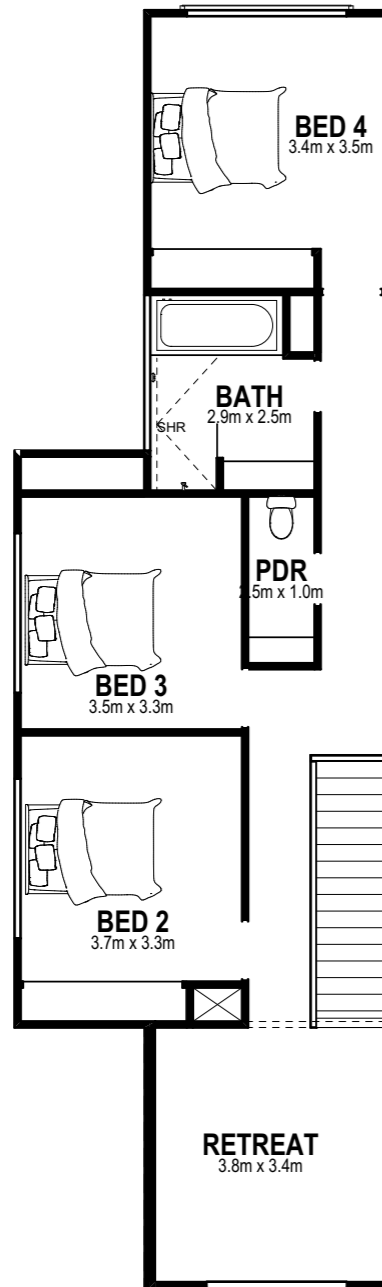

Ground Floor

